

AC93250

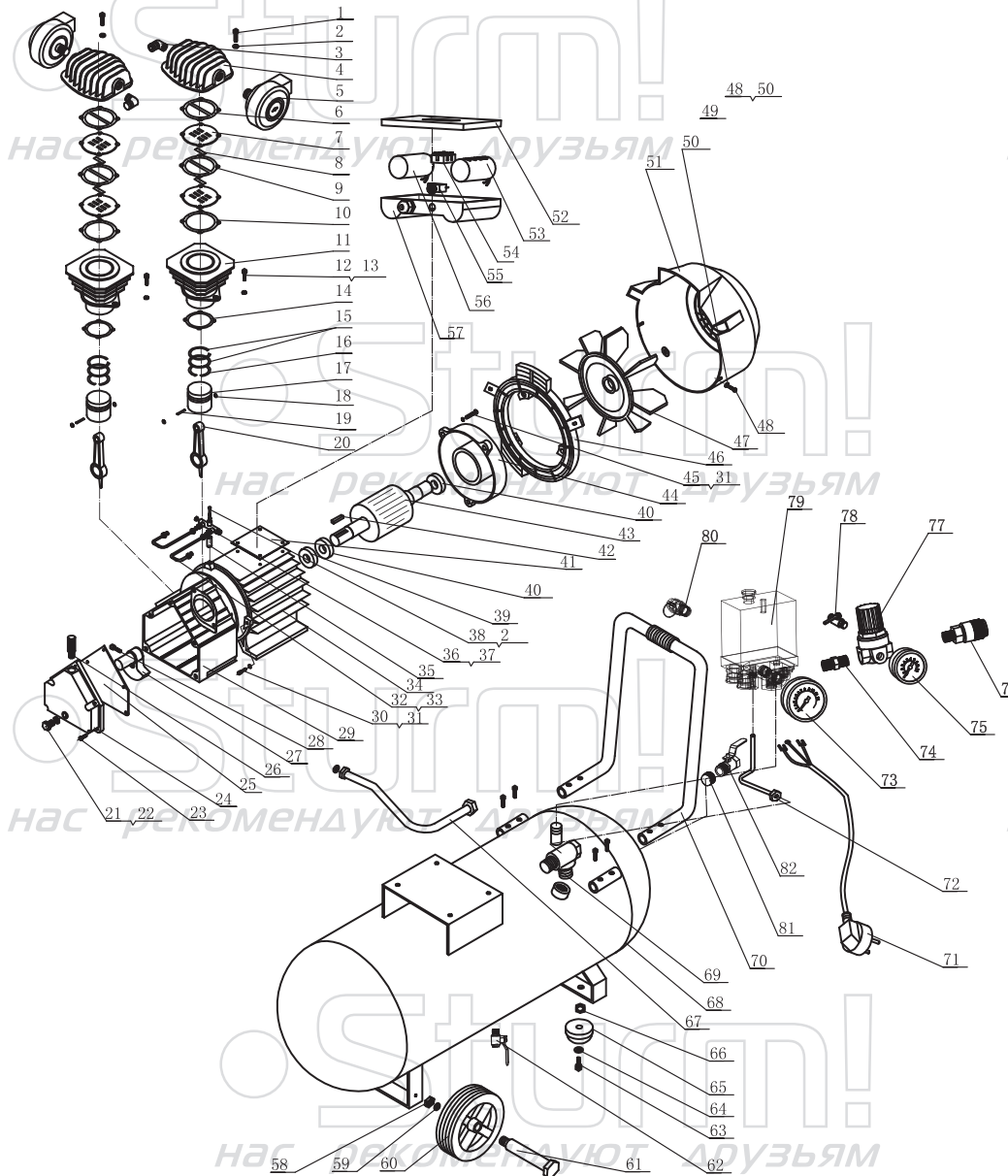

No.	DESCRIPTION	No.	DESCRIPTION
1	screw	42	flat key
2	washer	43	rotor
3	exhaust elbow	44	end cover of motor
4	cylinder head	45	screw
5	air filter	46	lining for fan housing
6	cylinder head gasket	47	fan
7	valve plate	48	screw
8	valve plate	49	screw
9	aluminum gasket	50	flat gasket
10	cylinder gasket	51	fan housing
11	cylinder	52	capacitor box cover
12	screw	53	start capacitor
13	washer	54	terminal
14	cylinder gasket	55	over-current protector
15	gas ring	56	running capacitor
16	oil ring	57	capacitor box
17	piston	58	nut
18	spring clip	59	washer
19	piston pin	60	wheel
20	rod	61	wheel axle
21	oil mirror	62	drain valve
22	oil mirror gasket	63	screw
23	screw	64	washer
24	crankcase front cover	65	foot mat
25	front cover gasket	66	nut
26	breather	67	release pipe
27	crankshaft	68	Tank
28	crankshaft screw	69	check valve
29	crankcase	70	handle with rubber sleeve
30	screw	71	cable with plug
31	washer	72	release pipe
32	U pipe	73	pressure gauge 50
33	paper mat	74	connection
34	stator including alu housing	75	pressure gauge 40
35	locating ring	76	quick connection
36	cross connection	77	regulator
37	unloading valve	78	1/4 ball Valve
38	screw	79	pressure switch
39	oil seal	80	safety valve
40	bearing 6205	81	air tank plug
41	gasket of capacitor box	82	1/2 ball Valve(optional)

AC93250-EX-RUS220830